

TRAFFIC SWINGING SINGLE LEAF DOORS WITH GRAVITY HINGES

ALL PRICES IN EURO, 2 MM THICK DOOR FRAME INCLUDED, VAT NOT INCLUDED

(TSD GR)

30.10.2023

- PH Insulation's traffic swinging doors are designed to separate premises with intensive traffic of personnel. The factory-made doors are ready for installation in supermarkets, restaurants, hospitals, food production facilities, etc. Doors can be equipped with oval windows of 200x500 or 300x580 mm.
- PH Insulation's doors with gravity hinges are set up faster with less adjustment compared to fixating hinges, need less maintenance and provide for increased dimensions of light opening.
- PH Insulation's traffic doors are not meant to completely seal the opening due to technical clearance gaps along the perimeter between the frame and the door leaf.

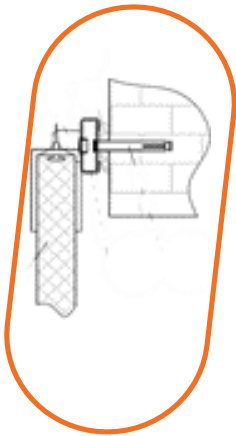

OVERHEAD FRAME

INSTALLATION OPENING, HEIGHT, MM	INSTALLATION OPENING, WIDTH, MM						
	700	800	900	1000	1100	1200	1300
1800	302	333	339	349	355	369	379
1900	306	338	345	355	361	375	386
2000	309	343	350	360	367	381	392
2100	313	349	356	366	373	387	398
2200	317	355	362	372	380	394	406
2300	321	360	367	378	385	400	412
2400	326	366	374	385	392	408	420
2500	329	371	379	390	398	414	426
2600	336	381	388	400	408	424	437
2700	341	387	395	407	415	432	444
2800	346	393	401	414	422	439	452
2900	352	401	409	422	431	448	461
3000	356	407	416	429	438	455	469
3100	360	412	421	434	443	461	475
3200	365	419	427	441	450	469	483
3300	372	428	437	451	460	479	493

RAL 9003

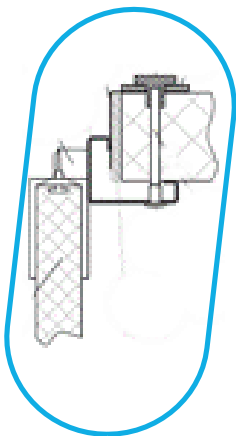

ANGULAR FRAME

INSTALLATION OPENING, HEIGHT, MM	INSTALLATION OPENING, WIDTH, MM						
	700	800	900	1000	1100	1200	1300
1800	318	350	356	367	373	388	399
1900	323	356	363	374	381	395	407
2000	327	362	369	380	387	402	414
2100	332	369	376	387	395	410	422
2200	337	375	383	394	402	418	430
2300	341	381	389	401	409	425	437
2400	346	387	395	407	415	432	444
2500	350	394	402	414	422	439	452
2600	357	402	411	423	432	449	463
2700	363	410	419	432	440	458	472
2800	369	418	426	440	449	467	481
2900	375	426	434	448	457	476	490
3000	379	430	440	453	463	482	496
3100	384	437	447	461	470	490	504
3200	393	448	458	472	482	502	517
3300	398	455	465	480	490	510	525

RAL 9003

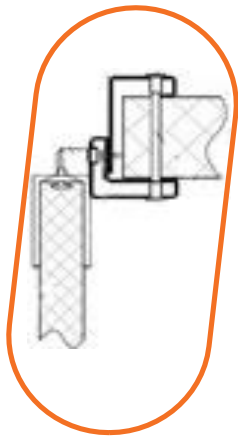

OVERLAPPING FRAME

RAL 9003	INSTALLATION OPENING, HEIGHT, MM	INSTALLATION OPENING, WIDTH, MM					
		700	800	900	1000	1100	1200
1800	374	408	417	430	438	456	469
1900	380	416	425	438	447	465	479
2000	388	426	435	449	458	476	490
2100	395	434	443	457	466	485	500
2200	403	444	453	468	477	497	511
2300	410	453	462	477	487	506	521
2400	420	465	475	489	500	520	536
2500	425	472	482	497	508	529	545
2600	433	482	492	508	519	540	556
2700	442	493	504	520	531	553	569
2800	450	502	513	530	541	563	580
2900	460	514	525	542	554	576	594
3000	462	519	530	547	559	582	599
3100	470	528	539	556	568	592	610
3200	485	545	557	575	587	611	630
3300	492	554	566	584	597	622	641

OUR DOORS ARE AVAILABLE IN CUSTOM SIZES TO INSURE BEST COMMERCIAL APPLICATION

TRAFFIC SWINGING DOUBLE LEAF DOORS WITH GRAVITY HINGES

ALL PRICES IN EURO, 2 MM THICK DOOR FRAME INCLUDED, VAT NOT INCLUDED

(TDD GR)

30.10.2023

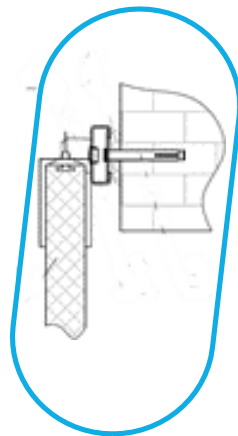

OVERHEAD FRAME

RAL 9003	INSTALLATION OPENING, HEIGHT, MM	INSTALLATION OPENING, WIDTH, MM			
		1000	1100	1200	1300
1800	538	541	548	551	606
1900	545	548	554	557	616
2000	552	555	562	565	626
2100	558	561	568	572	636
2200	564	568	575	578	646
2300	572	575	583	586	657
2400	578	582	589	593	667
2500	586	589	597	601	678
2600	597	601	608	612	693
2700				621	705
2800				630	717
2900				639	729
3000				649	742
3100				656	752
3200				665	764
3300				677	780

OVERHEAD FRAME

	INSTALLATION OPENING, HEIGHT, MM	INSTALLATION OPENING, WIDTH, MM				
		1500	1600	1700	1800	1900
RAL 9003	1800	609	612	614	617	620
	1900	618	621	624	627	630
	2000	630	633	636	639	642
	2100	639	643	646	649	652
	2200	649	653	656	659	663
	2300	660	664	667	671	674
	2400	670	674	677	681	685
	2500	681	685	689	693	696
	2600	697	701	705	708	712
	2700	709	713	717	721	725
	2800	721	725	729	733	738
	2900	733	737	742	746	750
	3000	746	751	755	760	764
	3100	757	762	766	771	775
	3200	769	774	778	783	788
	3300	785	790	795	799	804

OVERHEAD FRAME

	INSTALLATION OPENING, HEIGHT, MM	INSTALLATION OPENING, WIDTH, MM						
		2 000	2 100	2 200	2 300	2 400	2 500	2 600
RAL 9003	1800	623	626	628	631	634	637	640
	1900	633	636	639	642	645	648	651
	2000	645	648	651	654	657	660	664
	2100	656	659	662	665	668	672	675
	2200	666	669	673	676	680	683	686
	2300	678	681	685	688	692	695	699
	2400	688	692	696	699	703	707	710
	2500	700	704	708	712	715	719	723
	2600	716	720	724	728	732	736	740
	2700	729	733	737	741	745	749	753
	2800	742	746	750	754	758	762	767
	2900	754	759	763	767	772	776	780
	3000	769	773	777	782	786	791	795
	3100	780	784	789	793	798	802	807
	3200	792	797	802	806	811	816	820
	3300	809	814	819	824	828	833	838

ANGULAR FRAME

	INSTALLATION OPENING, HEIGHT, MM	INSTALLATION OPENING, WIDTH, MM				
		1000	1100	1200	1300	1400
RAL 9003	1800	557	560	567	570	626
	1900	565	568	575	578	638
	2000	572	575	582	586	648
	2100	580	584	591	594	660
	2200	589	592	600	603	672
	2300	596	599	607	611	683
	2400	603	606	614	618	693
	2500	611	615	623	627	706
	2600	623	628	636	640	722
	2700				651	736
	2800				661	750
	2900				671	763
	3000				678	773
	3100				687	785
	3200				699	800
3300				709	813	

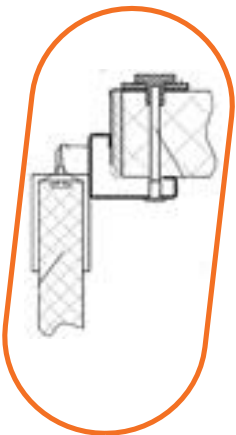

ANGULAR FRAME

	INSTALLATION OPENING, HEIGHT, MM	INSTALLATION OPENING, WIDTH, MM				
		1500	1600	1700	1800	1900
RAL 9003	1800	629	632	635	638	642
	1900	641	644	647	650	654
	2000	651	655	658	661	665
	2100	664	667	671	674	678
	2200	676	680	683	687	691
	2300	687	690	694	698	702
	2400	697	701	705	709	713
	2500	710	714	718	722	726
	2600	726	730	734	739	743
	2700	740	744	749	753	758
	2800	754	759	763	768	772
	2900	767	772	776	781	786
	3000	777	782	787	792	796
	3100	790	795	800	805	810
	3200	805	810	816	821	826
	3300	818	823	829	834	839

ANGULAR FRAME

	INSTALLATION OPENING, HEIGHT, MM	INSTALLATION OPENING, WIDTH, MM						
		2 000	2 100	2 200	2 300	2 400	2 500	2 600
RAL 9003	1800	645	648	651	654	657	660	663
	1900	657	660	664	667	670	673	677
	2000	668	672	675	678	682	685	689
	2100	681	685	688	692	695	699	703
	2200	694	698	702	705	709	713	716
	2300	706	709	713	717	721	725	728
	2400	717	721	725	729	733	737	741
	2500	730	734	738	742	746	750	754
	2600	747	751	756	760	764	768	772
	2700	762	766	771	775	779	784	788
	2800	777	781	786	790	795	799	804
	2900	790	795	800	804	809	813	818
	3000	801	806	811	815	820	825	830
	3100	814	819	824	829	834	839	844
	3200	831	836	841	846	851	856	861
	3300	844	849	854	860	865	870	875

OVERLAPPING FRAME

	INSTALLATION OPENING, HEIGHT, MM	INSTALLATION OPENING, WIDTH, MM				
		1000	1100	1200	1300	1400
RAL 9003	1800	622	626	635	639	697
	1900	631	636	644	648	710
	2000	640	645	653	658	723
	2100	652	657	665	670	739
	2200	661	666	675	680	751
	2300	671	676	685	689	764
	2400	683	688	697	702	780
	2500	692	698	707	712	794
	2600	705	711	720	725	811
	2700				737	826
	2800				749	841
	2900				761	856
	3000				767	865
	3100				778	879
	3200				799	905
	3300				811	919

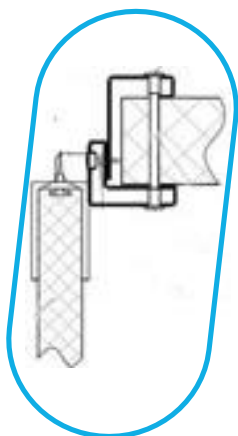

OVERLAPPING FRAME

	INSTALLATION OPENING, HEIGHT, MM	INSTALLATION OPENING, WIDTH, MM				
		1500	1600	1700	1800	1900
RAL 9003	1800	702	706	710	714	718
	1900	714	719	723	727	732
	2000	727	732	736	741	745
	2100	743	748	753	757	762
	2200	756	761	766	770	775
	2300	769	774	779	784	789
	2400	786	791	796	801	806
	2500	799	804	810	815	820
	2600	816	821	827	832	837
	2700	831	836	842	847	853
	2800	846	852	857	863	868
	2900	862	867	873	879	884
	3000	871	876	882	888	894
	3100	885	891	897	903	909
	3200	911	917	923	929	935
	3300	926	932	938	945	951

OVERLAPPING FRAME

	INSTALLATION OPENING, HEIGHT, MM	INSTALLATION OPENING, WIDTH, MM						
		2 000	2 100	2 200	2 300	2 400	2 500	2 600
RAL 9003	1800	723	727	731	735	740	744	748
	1900	736	741	745	749	754	758	762
	2000	750	754	759	763	768	772	777
	2100	767	771	776	780	785	790	795
	2200	780	785	790	794	799	804	809
	2300	794	799	804	809	814	819	824
	2400	811	816	821	826	831	837	842
	2500	825	830	835	841	846	851	856
	2600	843	848	853	859	864	869	875
	2700	858	864	869	875	880	886	891
	2800	874	880	885	891	896	902	908
	2900	890	896	902	907	913	919	925
	3000	900	905	911	917	923	929	934
	3100	915	921	927	933	939	945	951
	3200	942	948	954	960	966	973	979
	3300	958	964	970	976	983	989	995

OUR DOORS ARE AVAILABLE IN CUSTOM SIZES TO INSURE BEST COMMERCIAL APPLICATION

DOOR CATALOGUE CODES

TSD	SWINGING SINGLE LEAF DOORS
TDD	SWINGING DOUBLE LEAF DOORS
RIGHT / LEFT	HINGES ON THE RIGHT / HINGES ON THE LEFT

EXAMPLE OF DOOR CATALOGUE CODE: TSD 800 2000 40 RAL9003/RAL9003 ANG RIGHT

DOOR TYPE	DOORWAY WIDTH	DOORWAY HEIGHT	DOOR THICKNESS	COVERING MATERIAL		FRAME TYPE	HINGES LOCATION
				EXTERIOR METAL	INTERIOR METAL		
TSD	800	2 000	40	RAL9003	RAL9003	ANGULAR	RIGHT

ADDITIONAL OPTIONS FOR TRAFFIC SWINGING DOORS

ITEM	PRICE
TDD FRAME INSTALLATION HARDWARE TO INSULATED SANDWICH PANELS	12
TSD FRAME INSTALLATION HARDWARE TO INSULATED SANDWICH	8
TDD FRAME INSTALLATION HARDWARE TO A BRICK WALL	7
TSD FRAME INSTALLATION HARDWARE TO A BRICK WALL	4
FRAME INSTALLATION HARDWARE FOR STEEL STUD CONSTRUCTION	2
DOOR BLADE MATERIAL: AISI 304, PRICE FOR 1 SQ. M	30
DOOR BLADE MATERIAL: AISI 430, PRICE FOR 1 SQ. M	21
OVERHEAD FRAME AISI 304, PRICE FOR RUNNING METER	20
ANGULAR FRAME AISI 304, PRICE FOR RUNNING METER	32
OVERLAPPING FRAME AISI 304, PRICE FOR RUNNING METER	75
OVERHEAD FRAME AISI 430, PRICE FOR RUNNING METER	11
ANGULAR FRAME AISI 430, PRICE FOR RUNNING METER	18
OVERLAPPING FRAME AISI 430, PRICE FOR RUNNING METER	43
HIDDEN INSTALLATION HARDWARE FOR TSD	41
HIDDEN INSTALLATION HARDWARE FOR TDD	48
HIDDEN INSTALLATION HARDWARE FOR TSD WITH AISI 304 FRAME	56
HIDDEN INSTALLATION HARDWARE FOR TDD WITH AISI 304 FRAME	66
HIDDEN INSTALLATION HARDWARE FOR TSD WITH AISI 430 FRAME	50
HIDDEN INSTALLATION HARDWARE FOR TDD WITH AISI 304 FRAME	59

FACTORY INSTALLED BUMPERS FOR TSD

BUMPER MATERIAL	THICKNESS, MM	PRICE FOR SQ. M	PRICE FOR RUNNING METER	
			BOTTOM 0,25 M	BOTTOM 0,5 M
AISI 304	1,5	100	25	50
AISI 430	1,5	67	17	33
ALUMINIUM CHECKER PLATE	1,5	53	13	26
FLAT HDP PLASTIC	4,0	30	7	15
CURVED HDP PLASTIC	6,0	43	11	22

FACTORY INSTALLED BUMPERS FOR TDD

BUMPER MATERIAL	THICKNESS, MM	PRICE FOR SQ. M	PRICE FOR RUNNING METER	
			BOTTOM 0,25 M	BOTTOM 0,5 M
AISI 304	1,5	105	26	53
AISI 430	1,5	69	17	35
ALUMINIUM CHECKER PLATE	1,5	56	14	28
FLAT HDP PLASTIC	4,0	31	8	15
CURVED HDP PLASTIC	4,0	35	9	18
CURVED HDP PLASTIC	6,0	44	11	22

PACKAGING

ITEM	PRICE
STRETCH-WRAP	INCLUDED IN DOOR PRICE
CARDBOARD PACKAGING	CALCULATED INDIVIDUALLY FOR YOUR ORDER
WOODEN PACKAGING	CALCULATED INDIVIDUALLY FOR YOUR ORDER

